

I

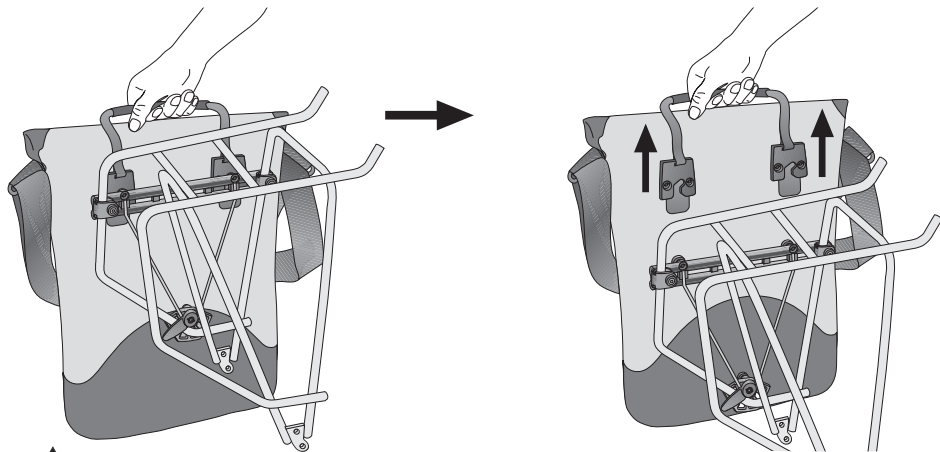

J

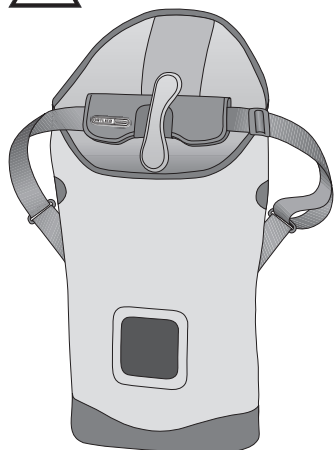

✓ = O.K.

K



- 1.) 100 Km (60 Miles)
- 2.) 500 km (300 Miles)
- 3.) 1000 km (600 Miles)
- 4.) 1500 km (900 Miles)
- ..... etc.

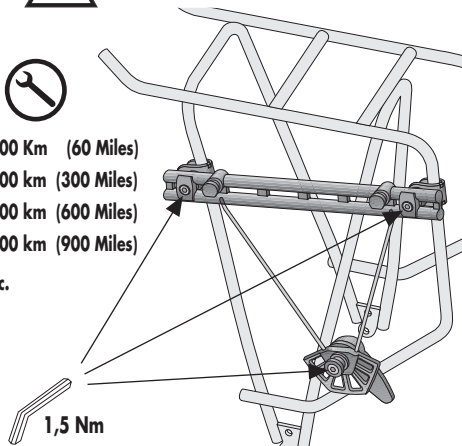

## ACCESSOIRES

+ = Art. # E 175

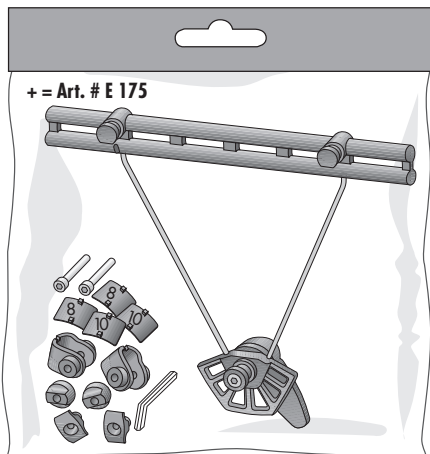

## CITY-BIKER QL 3

ORTLIEB WATERPROOF



- DE MONTAGEANWEISUNG:  
 GB ASSEMBLY INSTRUCTIONS:  
 FR INSTRUCTIONS DE MONTAGE:  
 IT ISTRUZIONI DI MONTAGGIO:  
 NL MONTAGE HANDLEIDING:  
 DK MONTERINGSVEJLEDNING:  
 ES INSTRUCCIONES DE MONTAJE:  
 SE MONTERINGSANVISNING:  
 NO MONTERINGSANVISNING:  
 FI ASENNUSOHJEET:  
 PL INSTRUKCJA MONTAZU:  
 JP 換気の良い所に保管してください。

- INHALT:  
 CONTENTS:  
 CONTENU:  
 CONTENUTO:  
 INHOUD:  
 INDHOLD:  
 CONTENIDO:  
 INNEHÅLL:  
 INNHOLD:  
 SISÄLLYS:  
 ZAWARTOSC:  
 火気厳禁



- 2x A 2x E  
 2x C 2x F  
 2x B 2x G  
 1x

